

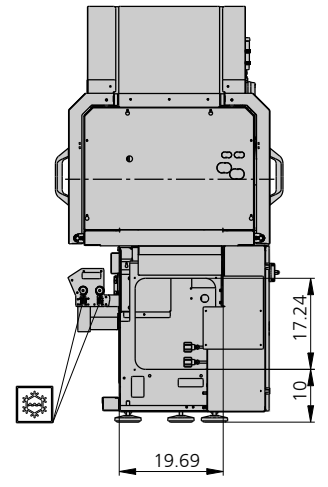
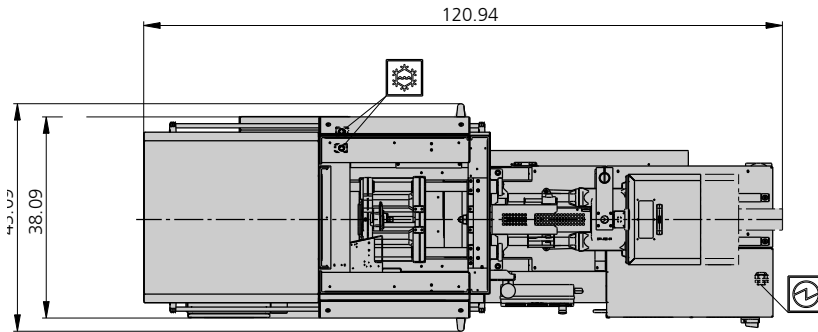
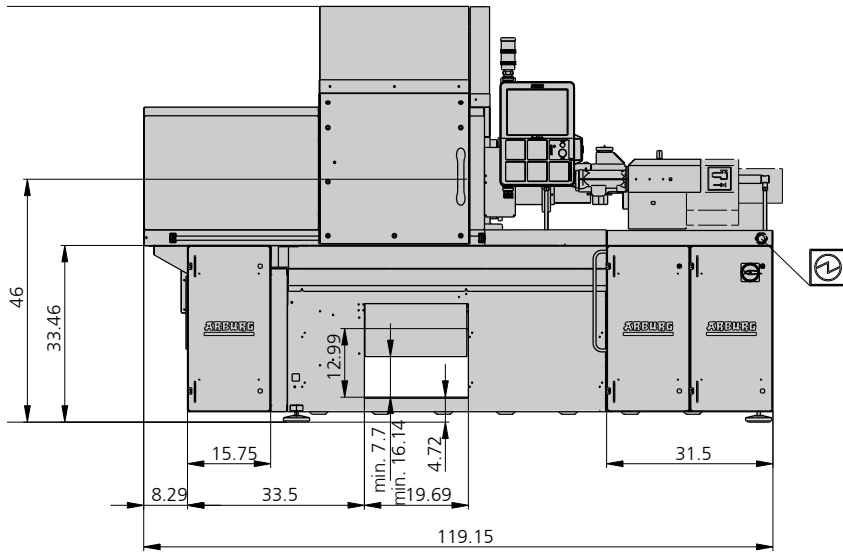

ALLROUNDER 270 S COMPACT

Distance between tie bars: 10.63 x 10.63" (270 x 270 mm)
Clamping force: 39 tons
Injection unit: 2.3 oz

ARBURG

MACHINE DIMENSIONS | 270 S COMPACT



-  Electrical connection
-  Cooling water connection

TECHNICAL DATA | 270 S COMPACT

Clamping unit			270 S		
with clamping force	max. tons		39		
Opening force stroke	max. tons inch		9.90 13.78		
Mold height, fixed variable	min. inch		7.87 ---		
Platen daylight fixed variable	max. inch		21.65 ---		
Distance between tie bars (w x h)	inch		10.63 x 10.63		
Mold mounting platens (w x h)	max. inch		14.96 x 14.96		
Weight of movable mold half	max. lbs		297		
Ejector force stroke	max. tons inch		2.20 3.94		
Dry cycle time EUROMAP ²	1 pump	min. s - inch	2.0 - 7.44		

Injection unit			2.3 oz		
with screw diameter	mm		20	25	30
Effective screw length	L/D		25	20	16.7
Screw stroke	max. inch		3.94		
Calculated stroke volume	max. cu. inch		1.9	3.0	4.3
Shot weight	max. oz / PS		1.0	1.6	2.3
Material throughput	max. lbs/h PS		12.1	17.6	20.9
	max. lbs/h PA6.6		6.2	8.8	10.8
Injection pressure	max. psi		36250	29000	20155
Holding pressure	max. psi		36250	29000	20155
Injection flow ²	max. cu. inch/s		3.9	6.1	8.9
Screw circumferential speed ²	max. ft./min		92	115	138
Screw torque	max. ft./lbs		89	111	133
Nozzle contact force retraction stroke	max. tons inch		5.50 7.09		
Heating capacity zones	kW		4.90 5		
Feed hopper	lbs		80		

Drive and connection			2.3 oz		
with injection unit			2.3 oz		
Net weight of machine	lbs		4400		
Sound press. level Ref. only ⁴	dB(A)		68 3		
Oil filling	gal.		34.35		
Drive power ²	max. kW		11		
Electrical connection ³	kW		18		
	Total	A	---		
	Machine	A	--- 25		
	Heat	A	17,5 ---		
Cooling water connection	max. °F		86		
	min. Δp psi		22 1"		

Machine type

with EUROMAP size designation ¹

270 S compact 39 tons 2.3 oz

All specifications relate to the basic machine version. Deviations are possible depending on variants, process settings and material type. Depending on the drive, certain combinations, e.g. max. injection pressure and max. injection flow may be mutually exclusive.

- 1) Clamping force (tons) - size of injection unit = max. stroke volume (cu. inch) x max. injection pressure (psi)
 - 2) Specifications depend on the drive config.
 - 3) Specifications relate to 230V/60 cycles | 460V/60 cycles.
 - 4) Detailed info in the operating instr.
- [] Information applies to alternative equipment.

MOLD INSTALLATION DIMENSIONS | 270 S COMPACT

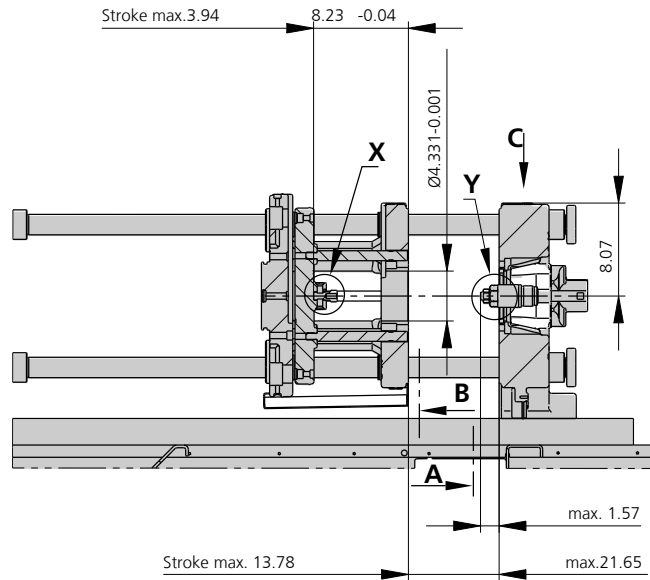

Center ejector | X

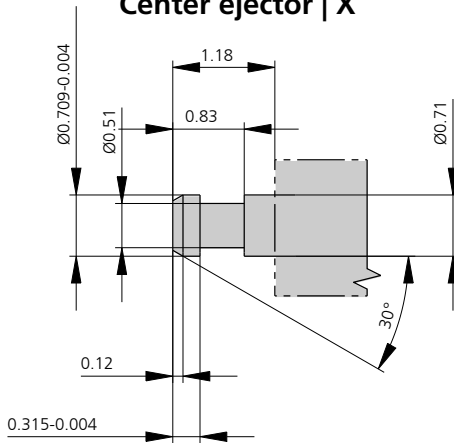

Bore in mold (if required) | Y

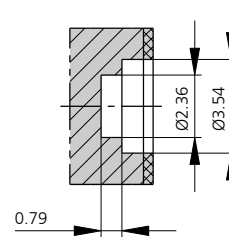

Robotic system mounting | C

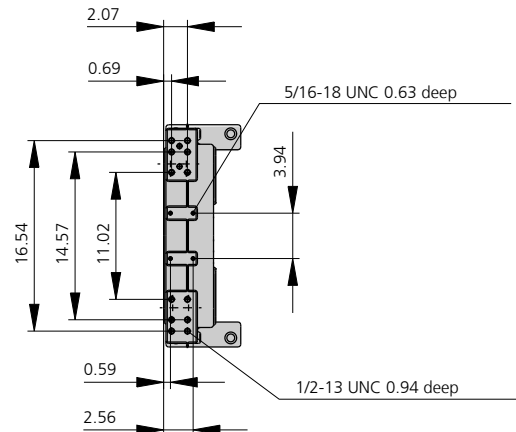

	Injection position of injection unit 100
a min.	55
a max.	185
b min.	70
c min.	70

MOLD INSTALLATION DIMENSIONS | 270 S COMPACT

Fixed mold mounting platen | A

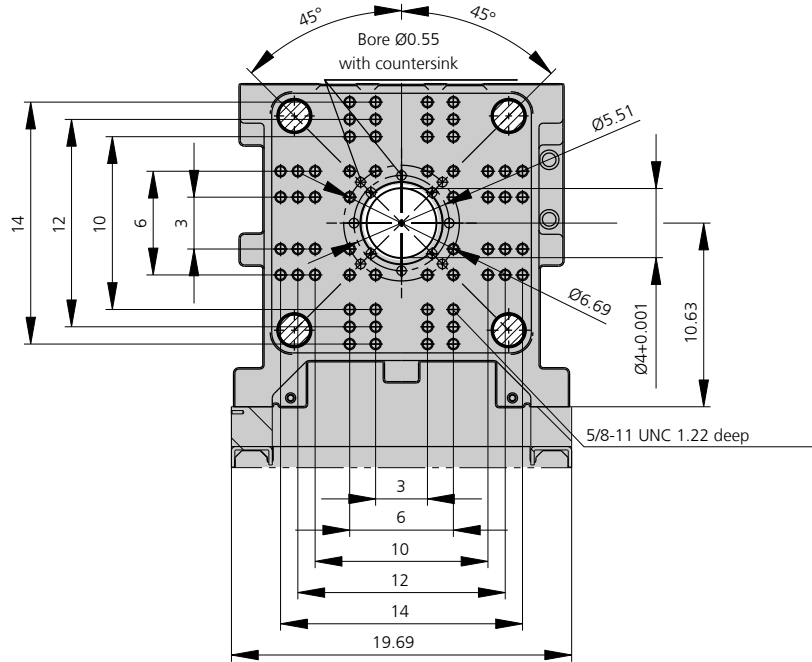

Moving mold mounting platen | B

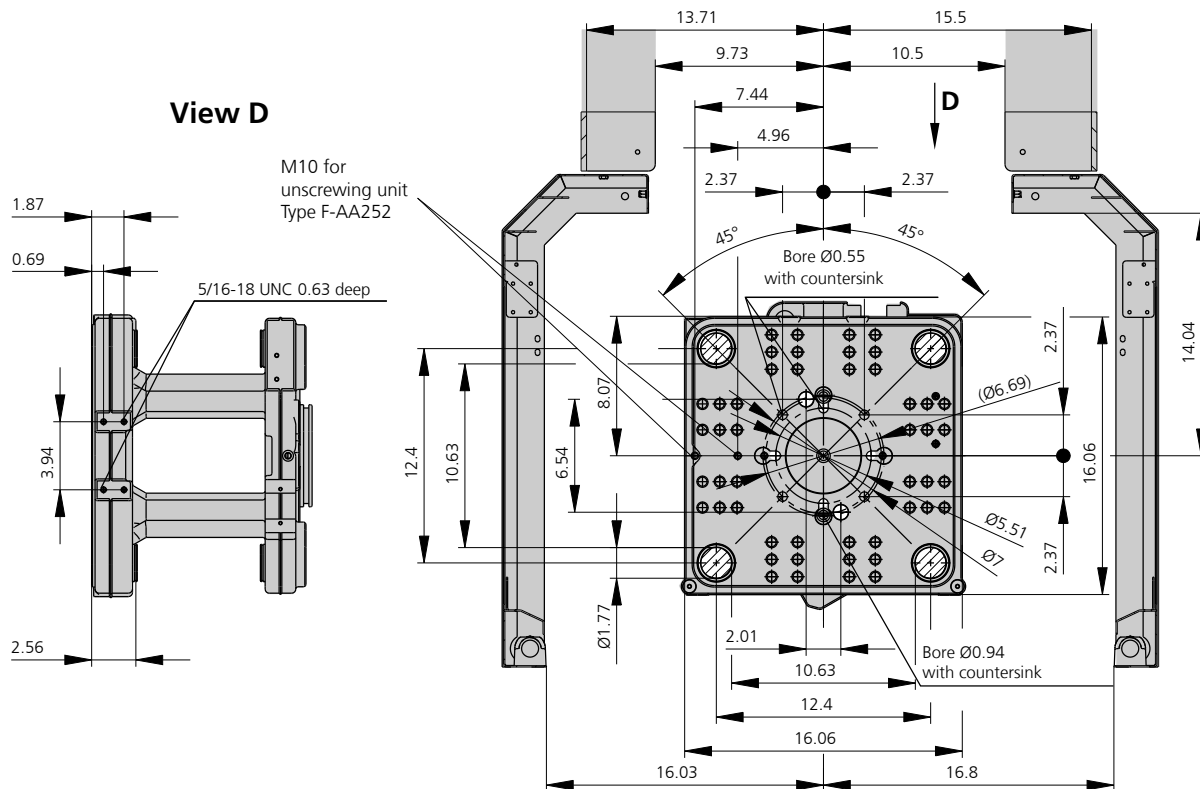

SHOT WEIGHTS | 270 S COMPACT

Theoretical shot weights for the most important materials

Injection units		2.3 oz				
Screw diameter	inch	0.79	0.98	1.18		
	mm	20	25	30		
Polystyrene	max. oz PS	1.0	1.6	2.3		
Styrene heteropolymerizates	max. oz SB	1.0	1.6	2.2		
	max. oz SAN, ABS ¹⁾	1.0	1.5	2.2		
Cellulose acetate	max. oz CA ¹⁾	1.1	1.8	2.6		
Celluloseacetobutyrate	max. oz CAB ¹⁾	1.1	1.7	2.4		
Polymethyl methacrylate	max. oz PMMA	1.1	1.6	2.4		
Polyphenylene oxide, mod.	max. oz PPO	1.0	1.5	2.1		
Polycarbonate	max. oz PC	1.1	1.7	2.4		
Polysulphone	max. oz PSU	1.1	1.7	2.5		
Polyamides	max. oz PA 6.6 PA 6 ¹⁾	1.0	1.6	2.3		
	max. oz PA 6.10 PA 11 ¹⁾	0.9	1.4	2.1		
Polyoximethylene (Polyacetal)	max. oz POM	1.2	1.9	2.8		
Polyethylene terephthalate	max. oz PET	1.2	1.9	2.7		
Polyethylene	max. oz PE-LD	0.8	1.2	1.7		
	max. oz PE-HD	0.8	1.2	1.8		
Polypropylene	max. oz PP	0.8	1.3	1.8		
Fluoropolymerides	max. oz FEP, PFA, PCTFE ¹⁾	1.6	2.5	3.6		
	max. oz ETFE	1.4	2.2	3.2		
Polyvinyl chloride	max. oz PVC-U	1.2	1.9	2.8		
	max. oz PVC-P ¹⁾	1.1	1.8	2.5		

1) average value

ARBURG GmbH + Co KG

Arthur-Hehl-Strasse
72290 Lossburg
Tel.: +49 7446 33-0
www.arburg.com
contact@arburg.com