

## **ALLROUNDER 570 E**

### **GOLDEN ELECTRIC**

Distance between tie bars: 570 x 570 mm

Clamping force: 2000 kN

Injection unit (acc. to EUROMAP): 400, 800

# **ARBURG**

# MACHINE DIMENSIONS | 570 E GOLDEN ELECTRIC

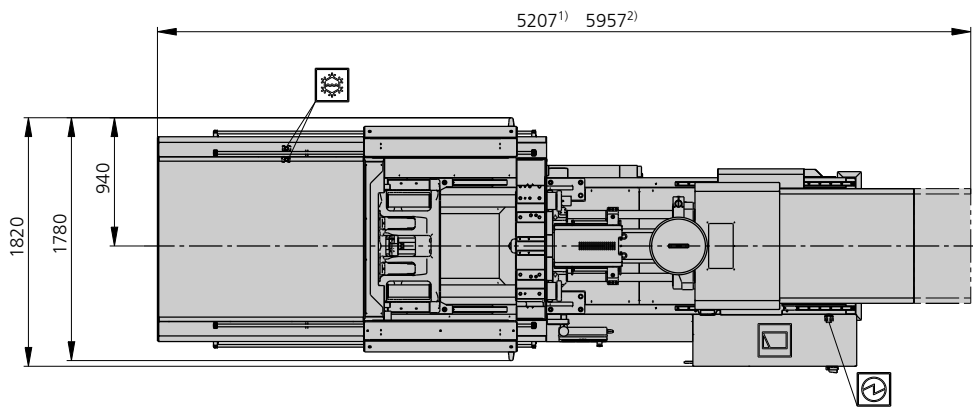
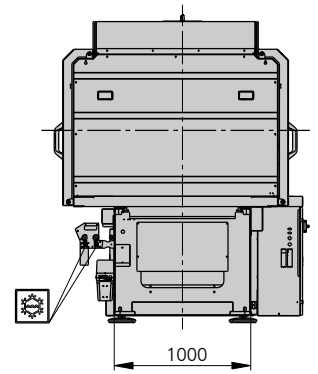
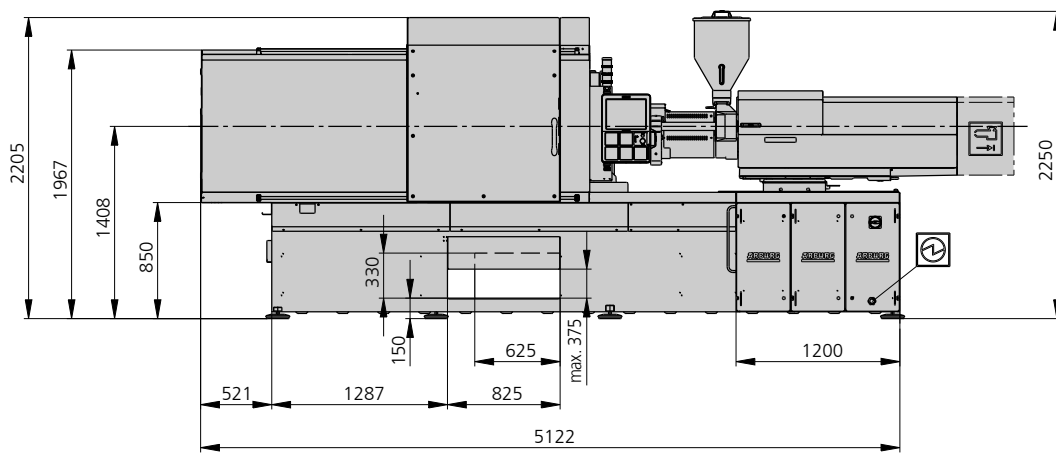

Electrical connection



Cooling water connection

1) Injection unit 400  
2) Injection unit 800

# TECHNICAL DATA | 570 E GOLDEN ELECTRIC

Clamping unit		570 E GOLDEN ELECTRIC	
with clamping force	max. kN	2000	
Opening force   stroke	max. kN   mm	---   450	
Mould height, fixed   variable	min.-max. mm	---   250-550	
Platen daylight fixed   variable	max. mm	---   700-1000	
Distance between tie bars (w x h)	mm	570 x 570	
Mould mounting platens (w x h)	max. mm	795 x 795	
Weight of movable mould half	max. kg	1300	
Ejector force   stroke	max. kN   mm	60   200	
Dry cycle time EUROMAP <sup>2</sup>	min. s - mm	1,8 - 399	

Injection unit		400			800		
with screw diameter	mm	35	40	45	45	50	55
Effective screw length	L/D	23	20	18	22	20	18
Screw stroke	max. mm	160			200		
Calculated stroke volume	max. cm <sup>3</sup>	154	201	254	318	392	474
Shot weight	max. g PS	141	184	232	291	359	434
Material throughput	max. kg/h PS	25	29	35	46	53	59
	max. kg/h PA6.6	12,5	15	17,5	23	27	30
Injection pressure	max. bar	2500	2000	1580	2470	2000	1650
Holding pressure time	max. s - bar	300-2090	300-1600	300-1260	300-1970	300-1600	300-1320
Injection flow <sup>2</sup>	max. cm <sup>3</sup> /s	126	164	208	174	216	260
		[162]	[214]	[270]	[228]	[282]	[340]
Injection speed <sup>5</sup>	max. mm/s	130			110		
		[170]			[140]		
Screw circumferential speed	max. m/min	27	31	35	28	31	34
Screw torque	max. Nm	480	550	610	900	1000	1100
Nozzle contact force   retraction stroke	max. kN   mm	60   300			70   400		
Heating capacity   zones	kW	9,4   5			19,9   8		
Feed hopper	l	50			50		

Drive and connection		400		800	
with injection unit					
Net weight of machine	kg	7800		8600	
Sound press. level   Insecurity <sup>4</sup>	dB(A)			55   3	
Electrical connection <sup>3</sup>	kW	30		47	
	Total	80		100	
	Machine	---		---	
	Heating	---		---	
Cooling water connection	max. °C			35	
	min. Δp bar			1,5   DN 25	

**Machine type**  
with EUROMAP size designation <sup>1</sup>  
570 E GOLDEN ELECTRIC 2000-400 | 800

**Upon request: other machine types and mould installation heights, screws, drive powers etc.**

All specifications relate to the basic machine version. Deviations are possible depending on variants, process settings and material type. Depending on the drive, certain combinations, e.g. max. injection pressure and max. injection flow may be mutually exclusive.

- 1) Clamping force (kN) - size of injection unit = max. stroke volume (cm<sup>3</sup>) x max. injection pressure (kbar)
  - 2) Specification of maximum injection flow at maximum injection pressure.
  - 3) Specifications relate to 400 V/50 Hz.
  - 4) Detailed info in the operating instr.
  - 5) Forward speed of plasticising screw at 1000 bar injection pressure.
- [ ] Specifications apply to alternative equipment.

# MOULD INSTALLATION DIMENSIONS | 570 E GOLDEN ELECTRIC

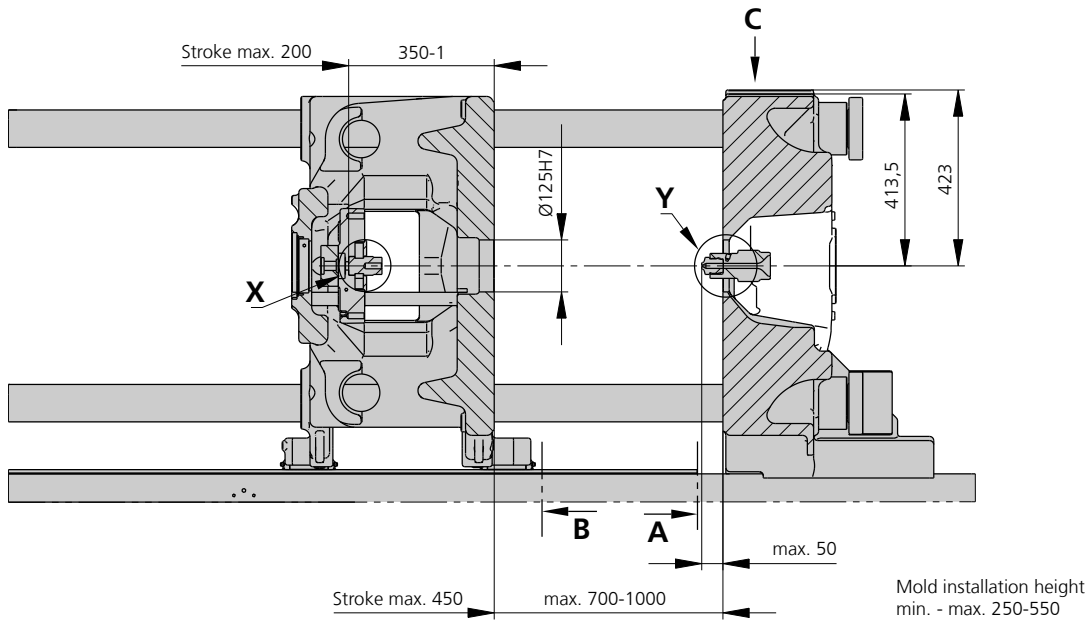

**Ejector bolt | X**

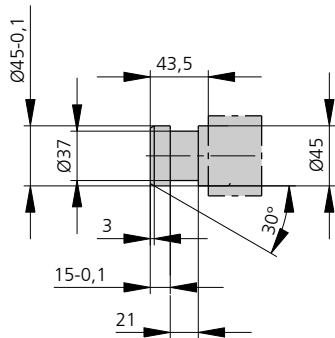

**Bore in mould (if required) | Y**

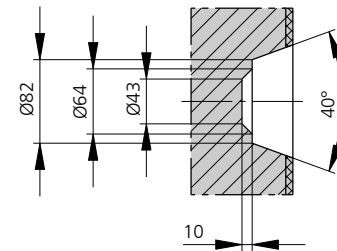

**Robotic system mounting | C**

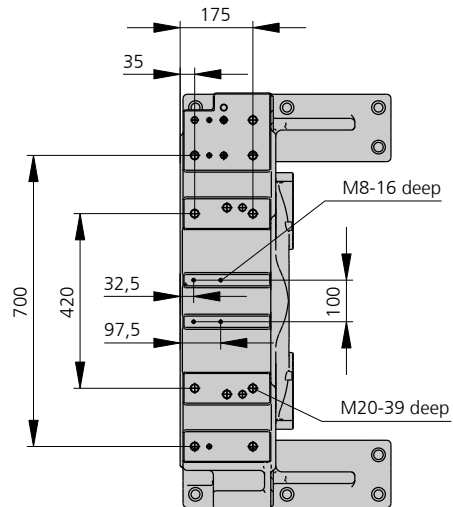

# MOULD INSTALLATION DIMENSIONS | 570 E GOLDEN ELECTRIC

## Fixed mould mounting platen | A

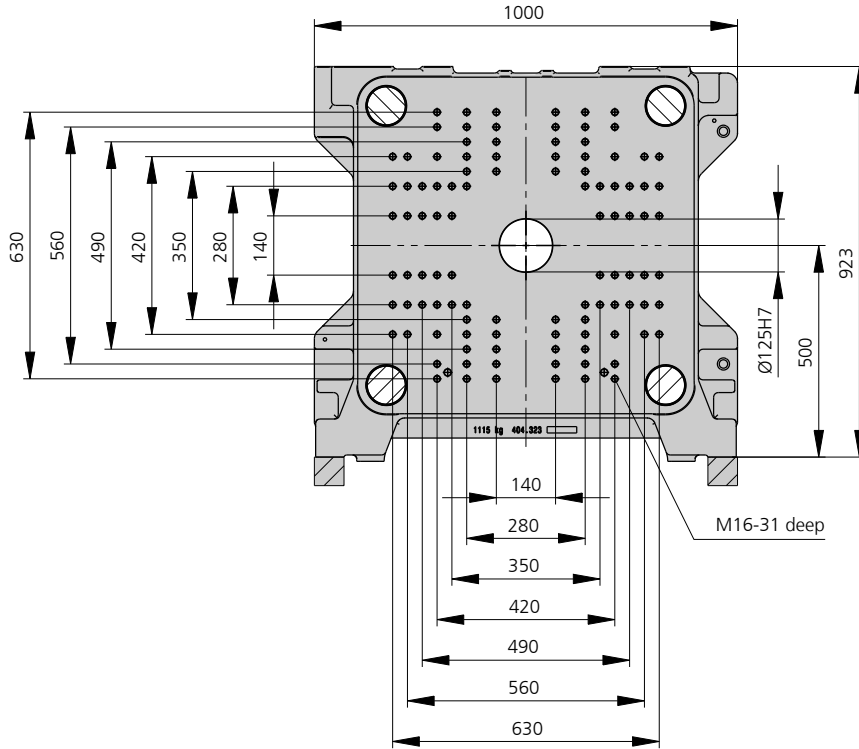

## Moving mould mounting platen | B

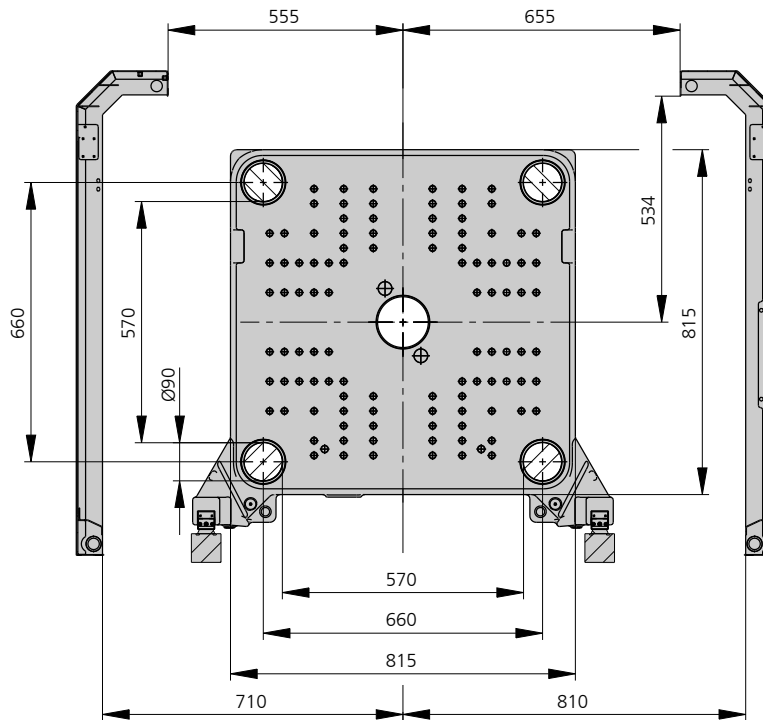

# SHOT WEIGHTS | 570 E GOLDEN ELECTRIC

## Theoretical shot weights for the most important injection moulding materials

Injection units according to EUROMAP		400			800		
Screw diameter	mm	35	40	45	45	50	55
Polystyrene	max. g PS	141	184	232	291	359	434
Styrene heteropolymerizates	max. g SB	137	179	227	284	350	424
	max. g SAN, ABS <sup>1)</sup>	135	176	223	278	344	416
Cellulose acetate	max. g CA <sup>1)</sup>	158	207	262	327	404	488
Celluloseacetobutyrate	max. g CAB <sup>1)</sup>	147	192	243	304	375	454
Polymethyl methacrylate	max. g PMMA	145	190	240	300	371	449
Polyphenylene ether, mod.	max. g PPE	131	171	216	270	333	403
Polycarbonate	max. g PC	148	193	244	305	377	456
Polysulphone	max. g PSU	153	199	252	316	390	471
Polyamides	max. g PA 6.6   PA 6 <sup>1)</sup>	140	183	231	289	357	431
	max. g PA 6.10   PA 11 <sup>1)</sup>	131	171	216	270	333	403
Polyoximethylene (Polyacetal)	max. g POM	174	227	287	359	443	536
Polyethylene terephthalate	max. g PET	167	219	277	346	427	517
Polyethylene	max. g PE-LD	106	139	176	219	271	328
	max. g PE-HD	110	143	181	227	280	339
Polypropylene	max. g PP	112	146	185	232	286	346
Fluoropolymerides	max. g FEP, PFA, PCTFE <sup>1)</sup>	225	294	372	465	574	695
	max. g ETFE	196	256	324	408	504	609
Polyvinyl chloride	max. g PVC-U	170	222	281	351	434	525
	max. g PVC-P <sup>1)</sup>	157	205	260	324	401	485

1) average value

**ARBURG GmbH + Co KG**  
 Arthur-Hehl-Strasse  
 72290 Lossburg  
 Tel.: +49 7446 33-0  
 www.arburg.com  
 contact@arburg.com