

ALLROUNDER 520 A

Distance between tie bars: 520 x 520 mm

Clamping force: 1500 kN

Injection unit (acc. to EUROMAP): 290, 400, 800

ARBURG

MACHINE DIMENSIONS | 520 A

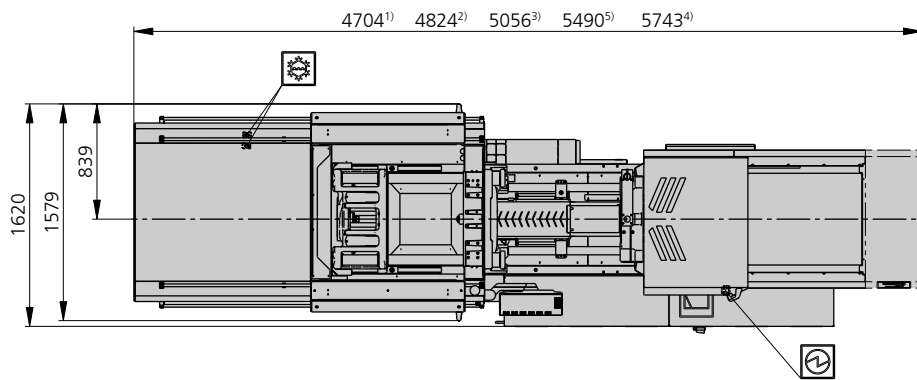
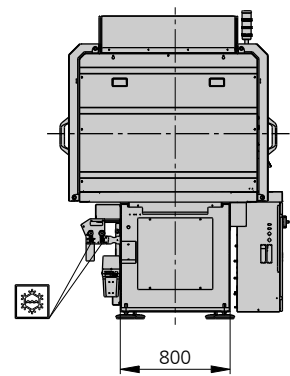
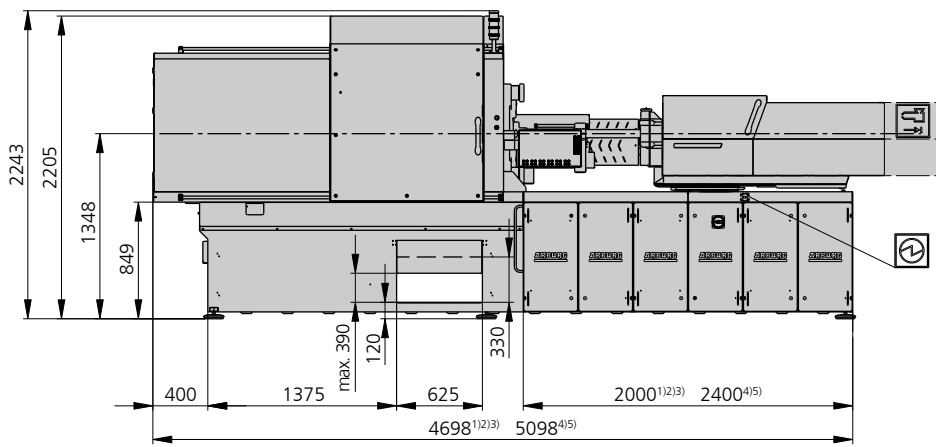

Electrical connection



Cooling water connection

- 1) injection unit 290 COMFORT
- 2) injection unit 290 PREMIUM/ULTIMATE
- 3) injection unit 400
- 4) injection unit 800 COMFORT (253 mm longer with COMFORT performance variant in horizontal arrangement)
- 5) injection unit 800 PREMIUM/ULTIMATE

TECHNICAL DATA | 520 A

Clamping unit			520 A		
with clamping force	max. kN		1500		
Opening force stroke	max. kN mm		--- 450		
Mould height, fixed variable	min.-max. mm		--- 250-550		
Platen daylight fixed variable	max. mm		--- 700-1000		
Distance between tie bars (w x h)	mm		520 x 520		
Mould mounting platens (w x h)	max. mm		695 x 695		
Weight of movable mould half	max. kg		1000		
Ejector force stroke	max. kN mm		40 175		
Dry cycle time EUROMAP	Comfort	min. s - mm	1,5 - 364		
	Premium	min. s - mm	1,3 - 364		
	Ultimate	min. s - mm	1 - 364		

Injection unit			290			400			800		
with screw diameter	mm		30	35	40	35	40	45	45	50	55
Effective screw length	L/D		23,3	20	17,5	23	20	18	22	20	18
Screw stroke	max. mm		150			160			200		
Calculated stroke volume	max. cm ³		106	144	188	154	201	254	318	392	474
Shot weight	max. g PS		97	132	172	141	184	232	291	359	434
Material throughput	max. kg/h PS		17	20,5	24,5	25	29	35	46	53	59
	max. kg/h PA6.6		8,5	10,5	12,5	12,5	15	17,5	23	27	30
Injection pressure	max. bar		2500	2000	1530	2500	2000	1580	2470	2000	1650
Holding pressure time	max. s - bar		300-2180	300-1600	300-1220	300-2090	300-1600	300-1260	300-1980	300-1600	300-1320
Injection flow ²	Comfort [+]	max. cm ³ /s	105 [140]	144 [191]	188 [250]	125 [163]	163 [213]	207 [271]	175 [239]	216 [295]	261 [356]
	Premium	max. cm ³ /s	140	191	250	163	213	271	239	295	356
	Ultimate [+]	max. cm ³ /s	212 [283]	288 [384]	376 [501]	241 [313]	314 [408]	398 [517]	318 [477]	394 [591]	476 [714]
Injection speed ⁵	Comfort [+]	max. mm/s	215 [280]			190 [240]			150 [200]		
	Premium	max. mm/s	280			240			200		
	Ultimate [+]	max. mm/s	350 [400]			300 [325]			240 [300]		
Screw circumferential speed	max. m/min		51	60	69	53	60	68	54	60	66
Screw torque	max. Nm		320	380	430	480	550	610	900	1000	1100
Nozzle contact force retraction stroke	max. kN mm		50 300			60 300			70 400		
Heating capacity zones	kW		7,7 5			9,7 5			19,9 8		
Feed hopper	l		---			---			---		

Drive and connection			Comfort			Premium			Ultimate		
with injection unit			290	400	800	290	400	800	290	400	800
Net weight of machine	kg		6980	7100	7900	6980	7100	7900	6980	7100	7900
Sound press. level Insecurity ⁴	dB(A)		63 3			63 3			63 3		
Electrical connection ³	kW		23	28	47	27	33	51	27	33	51
	Total	A	63	80	100	80	100	125	80	100	125
	Machine	A	---			---			---		
Heating	A	---			---			---			
Cooling water connection	max. °C		30			30			30		
	min. Δp bar		1,5 DN 25			1,5 DN 25			1,5 DN 25		

Machine type
with EUROMAP size designation ¹
520 A 1500-290 | 400 | 800

Upon request: other machine types and mould installation heights, screws, drive powers etc.

All specifications relate to the basic machine version. Deviations are possible depending on variants, process settings and material type. Depending on the drive, certain combinations, e.g. max. injection pressure and max. injection flow may be mutually exclusive.

- 1) Clamping force (kN) - size of injection unit = max. stroke volume (cm³) x max. injection pressure (kbar)
 - 2) Specification of maximum injection flow at maximum injection pressure.
 - 3) Specifications relate to 400 V/50 Hz.
 - 4) Emission sound pressure level at the workplace. Detailed information in the operating instructions.
 - 5) Forward speed of plasticising screw at 1000 bar injection pressure.
- [] Specifications apply to alternative equipment.

MOULD INSTALLATION DIMENSIONS | 520 A

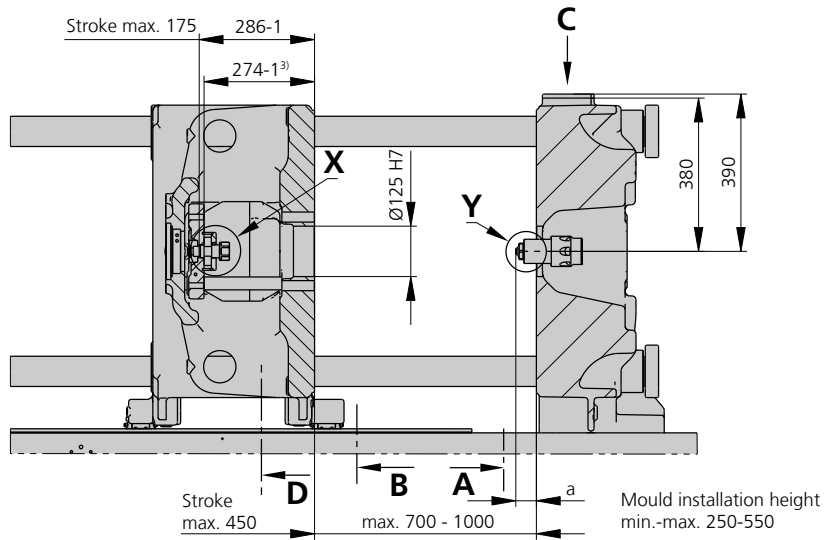

a max.	Injection unit	
		290
Standard	40	50
Thermoset	20	50

Ejector bolt | X

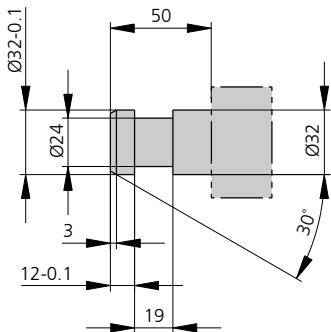

Bore in mould (if required) | Y

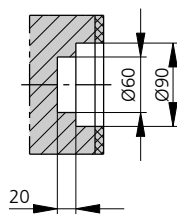

Injection unit 290

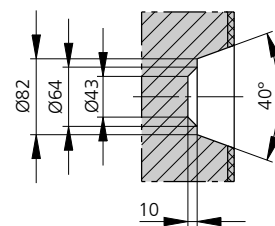

Injection unit 400 / 800

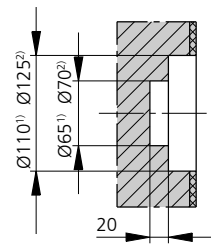

Injection unit 400⁽¹⁾ / 800⁽²⁾
Thermoset version

Closing force for spring moulds / during injection compression moulding*

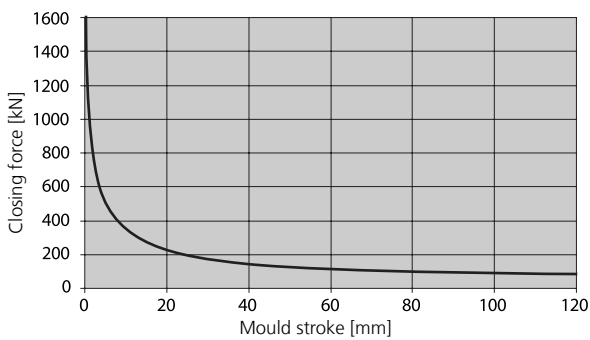

* automatic locking force adjustment up to 30 kN

Ejector plate | D

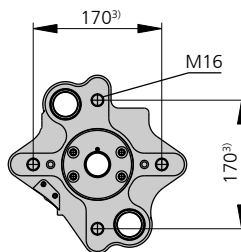

Robotic system mounting | C

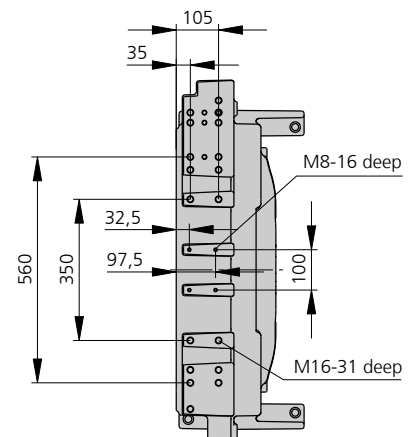

3) Positions of ejector plate

MOULD INSTALLATION DIMENSIONS | 520 A

Fixed mould mounting platen | A

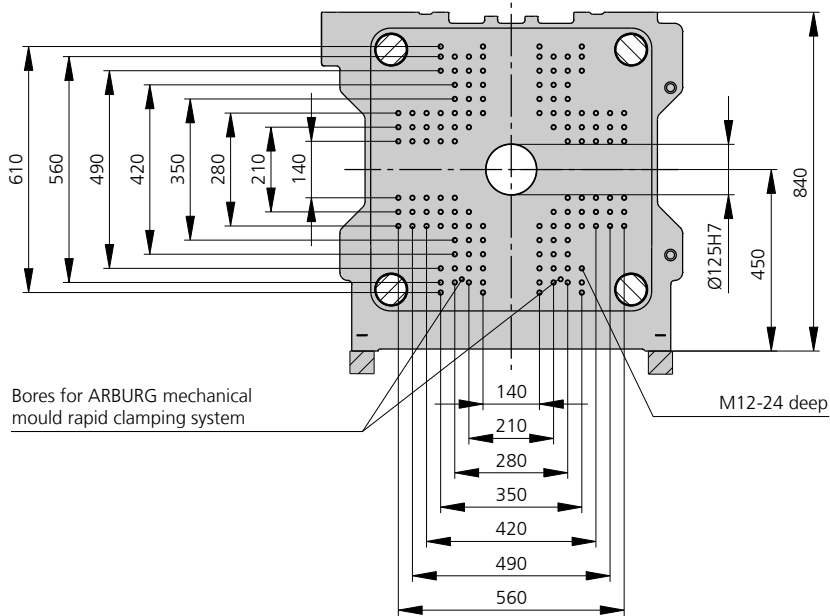

Moving mould mounting platen | B

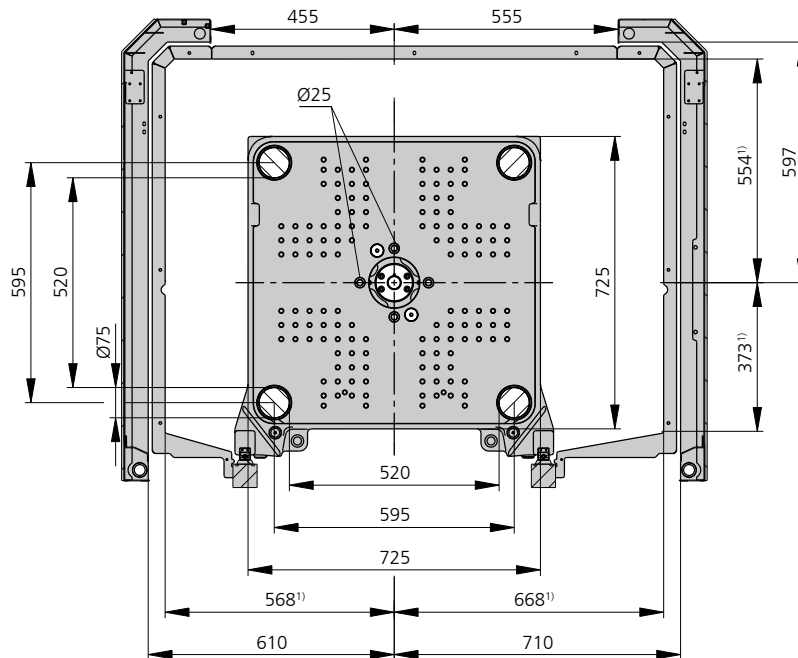

1) Dimensions are valid for a distance between mould mounting platens of 960 mm or more.

SHOT WEIGHTS | 520 A

Theoretical shot weights for the most important injection moulding materials

Injection units according to EUROMAP		290			400			800		
Screw diameter	mm	30	35	40	35	40	45	45	50	55
Polystyrene	max. g PS	97	132	172	141	184	232	291	359	434
Styrene heteropolymerizates	max. g SB	95	129	168	137	179	227	284	350	424
	max. g SAN, ABS ¹⁾	93	126	165	135	176	223	278	344	416
Cellulose acetate	max. g CA ¹⁾	109	148	194	158	207	262	327	404	488
Celluloseacetobutyrate	max. g CAB ¹⁾	101	138	180	147	192	243	304	375	454
Polymethyl methacrylate	max. g PMMA	100	136	178	145	190	240	300	371	449
Polyphenylene ether, mod.	max. g PPE	90	122	160	131	171	216	270	333	403
Polycarbonate	max. g PC	102	139	181	148	193	244	305	377	456
Polysulphone	max. g PSU	105	143	187	153	199	252	316	390	471
Polyamides	max. g PA 6.6 PA 6 ¹⁾	96	131	171	140	183	231	289	357	431
	max. g PA 6.10 PA 11 ¹⁾	90	122	160	131	171	216	270	333	403
Polyoximethylene (Polyacetal)	max. g POM	120	163	213	174	227	287	359	443	536
Polyethylene terephthalate	max. g PET	115	157	205	167	219	277	346	427	517
Polyethylene	max. g PE-LD	73	100	130	106	139	176	219	271	328
	max. g PE-HD	76	103	134	110	143	181	227	280	339
Polypropylene	max. g PP	77	105	137	112	146	185	232	286	346
Fluoropolymerides	max. g FEP, PFA, PCTFE ¹⁾	155	211	276	225	294	372	465	574	695
	max. g ETFE	136	185	242	196	256	324	408	504	609
Polyvinyl chloride	max. g PVC-U	117	159	208	170	222	281	351	434	525
	max. g PVC-P ¹⁾	108	147	192	157	205	260	324	401	485

1) average value

ARBURG GmbH + Co KG
 Arthur-Hehl-Strasse
 72290 Lossburg
 Tel.: +49 7446 33-0
 www.arburg.com
 contact@arburg.com